

Aluminum systems

Modern and functional window-door solutions for your home

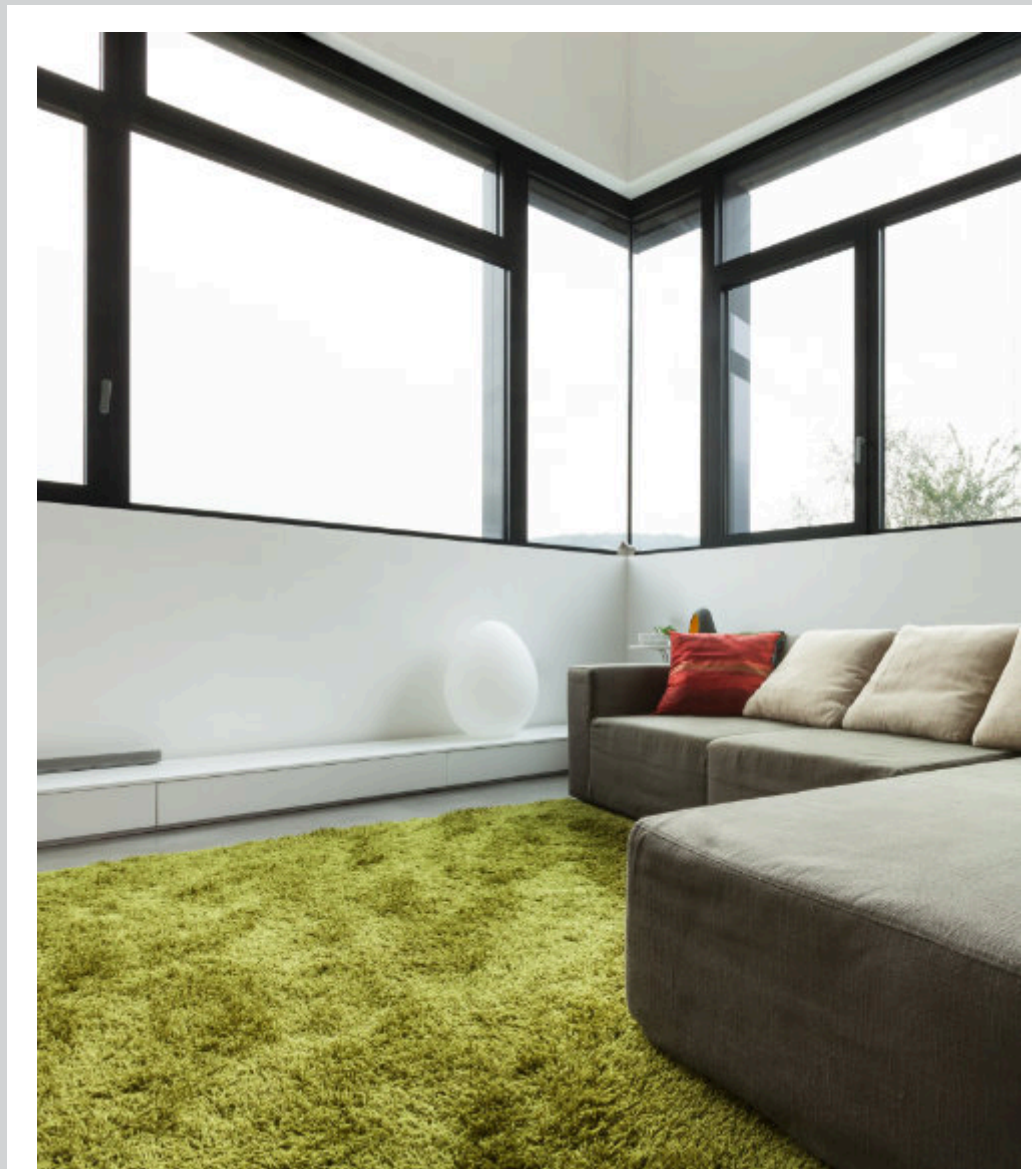

HANDLES AND ROSETTES



Stainless steel handle with a long plate.



Stainless steel handle and rosette with a separate plate and a BKS insertion with a clutch.



Stainless steel anti-theft rosette on the outside and an anti-theft insertion BKS 5000 Livius series in the 6th class with a safety card.

GRIPS



Rounded, stainless steel Grips Φ 30 installed vertically



Rounded, stainless steel Grips Φ 30 installed at the 45° angle



Rectangular, stainless steel Grips 40 x 20 mm installed vertically



Rectangular, stainless steel Grips 40 x 20 mm installed at the 45° angle



Stainless steel arc-grips Φ 30 installed vertically.



Stainless steel Grips with a fingerprint reader.

Accessible lengths 600 mm, 800 mm, 1000 mm, 1400 mm, 1600 mm, 1800 mm.

Accessible lengths 800 mm, 1200 mm

Accessible lengths 1400 mm, 1600 mm, 1800 mm

HINGES



2-wings hinges with adjustment in 3 directions in the color of the frame

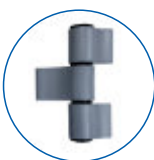

3-wings hinges with adjustment in 3 directions in the color of the frame



3-wings Rollband hinges with adjustment in 3 directions either in the color of the frame or from stainless steel



Concealed Hinges VL-BAND

ACCESS CONTROL



Fingerprint reader or a numeric keypad mounted in the panel, integrated with the motors bolting automatic doors in 3 points with magnetic space between frame and the panel.



Bluetooth & Code – a reader integrated with your mobile phone, connected with the bolting engine. It allows door opening with the keypad and the telephone using Bluetooth technology.



GU Controller IO – integrated with the bolting engine and Somfy Tahoma app. It allows you to open the door from any place on the globe using your mobile phone.



FUNCTIONAL SYSTEM

A system intended for designing windows, doors and partition wall segments **without thermal insulation**, used mainly in public and industrial buildings. The system provides a number of possibilities, such as a smoke-proof function, which is particularly applicable in this type of constructions.

WIDE RANGE OF SOLUTIONS

Econoline system is compatible with other Alipast systems thanks to the use of common glazing beads, gaskets and fittings. It allows the construction of partition walls, sliding and swinging doors, as well as joining walls at any angle and with any design. In addition, based on the Econoline system, it is possible to design **panel doors**, which have the above-mentioned system as their supporting structure. A wide range of filling panels, available in different colors and designs, as well as frame surface flush with the panel, provide an elegant appearance and allow great freedom of space arrangement inside and outside residential and public buildings.

AESTHETICS

The system is characterized by a wide range of solutions to improve both comfort of use and aesthetics of the structure. Glazing beads are available in straight and rounded variants. The system construction allows the use of elegant **rebate hinges** and the possibility to bend profiles in order to obtain products ideally suited to the customer's requirements.



CROSS-SECTIONS

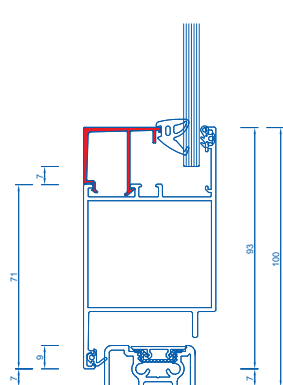

Cross-section through the low threshold and door leaf
EL 024

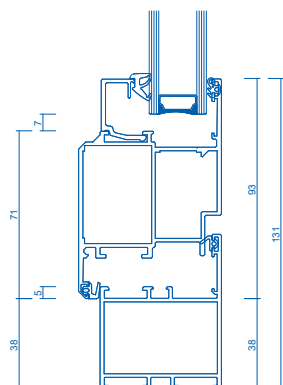

Cross-section through window frame and sash
EL 011 + EL 022

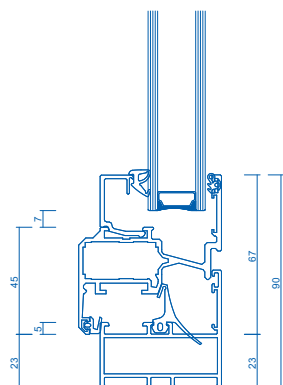

Cross-section through window frame and sash
EL 010 + VL 820

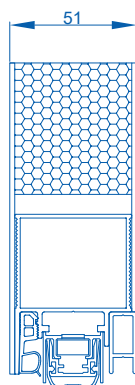

Cross-section through panel door - falling threshold option

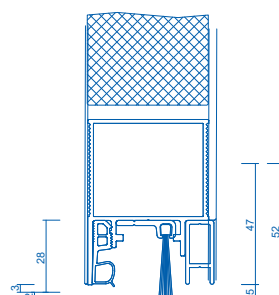

Cross-section through the sash - option with low threshold



OPTIMAL THERMAL PARAMETERS

Insulated window and door system that allows the construction of various types of windows and doors, also in IP i+ version with improved thermal parameters, making it possible to achieve the thermal insulation value of $U_f = 1.28 \text{ W/m}^2\text{K}$ through the use of special thermal pads inserted between the thermal breaks and around the glass. The depth of the frame in the same system in 65 mm and the depth of sash is 74 mm.

WIDE RANGE OF SOLUTIONS

The system offers various constructional possibilities. Starting with windows of all sorts, from **outward opening (IP OUT)** and **concealed sash (IP SU)**, through sliding and rotating systems with vertical or horizontal pivot, to doors with improved thermal properties, opening outwards or inwards.

AESTHETICS

A wide range of sections of the offered system, the possibility to bend profiles in order to obtain various arched constructions, two types of glazing beads to choose from, a wide range of glazing, profile shapes that enable installation of various types of fittings, including **concealed hinges**, and the variety of subsystems provide broad possibilities of shaping external developments and obtaining the required aesthetics of the construction.

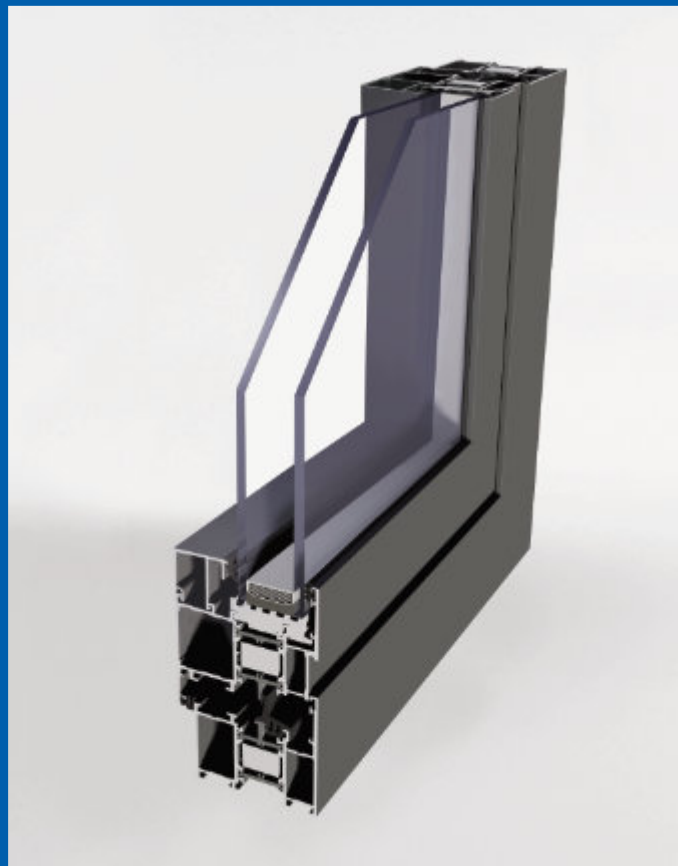

CROSS-SECTIONS THROUGH WINDOWS IP | IP i | IP i+

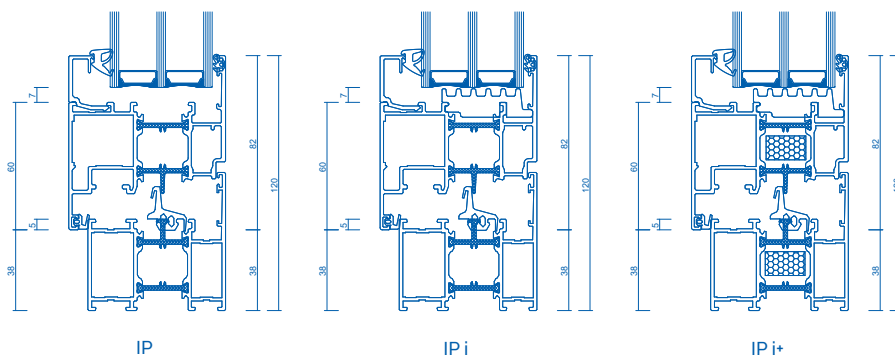

IMPERIAL 65 -

OPTIONS AND SUBSYSTEMS

Imperial system and its thermal options (**IP** or **IP +**) and subsystems (**IP OUT**, **IP SU** and **IP 800**) allow a wide range of possibilities for external construction.

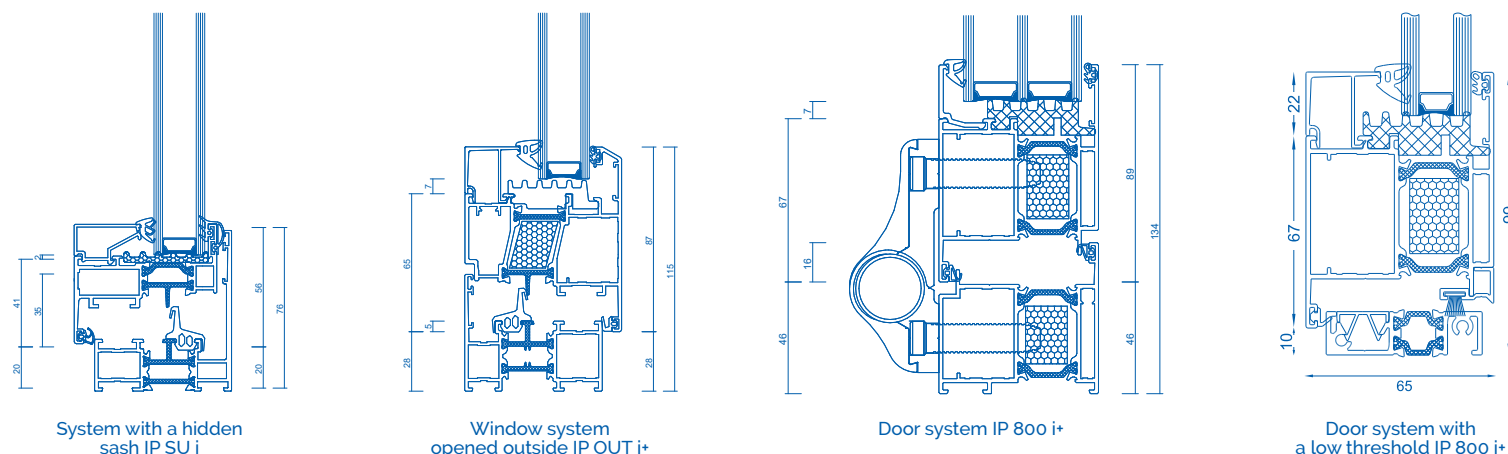

GOOD THERMAL PROPERTIES

Thermal insulators, a central chambre gasket and special glazing gaskets make it possible to achieve the **U_f value of 1.08 W/m²K**. The depth of the window sashes is 84 mm and the depth of the frame is 75 mm. The possibility of using additional thermal inserts in the **SP i** and **SP i+** systems. This all contributes to very good thermal properties.

AESTHETICS

Available solutions allow the use of profiles in aluminium and glass buildings. The possibility of bending profiles allows for construction of building facades, taking into account the user's special needs in terms of functionality, aesthetics and durability. Solutions of this type make it possible to give a building an individual character and ensure the realization of an architectural vision using economic solution.

GREAT QUALITY AT A REASONABLE PRICE

Superial 75 is a warm, **3-chamber system** at an attractive price. It is ideal for use in residential, public and industrial buildings. It proves its worth in all kinds of windows and external shop windows.

WIDE RANGE OF SOLUTIONS

By using Superial 75 system, it is possible to make doors with both inward and outward opening, **outward opening windows (SP OUT)** as well as **windows with a hidden sash (SP SU)**. An interesting option is the **Superial 800** system, which allows production of only the **entrance doors** at a very favorable price.

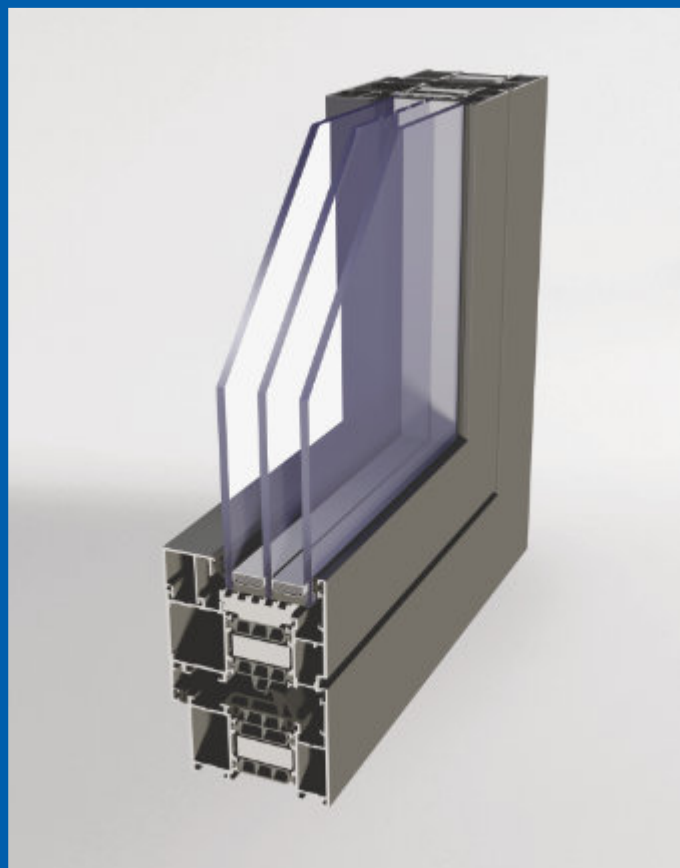

CROSS-SECTIONS THROUGH WINDOWS SP | SP i | SP i+

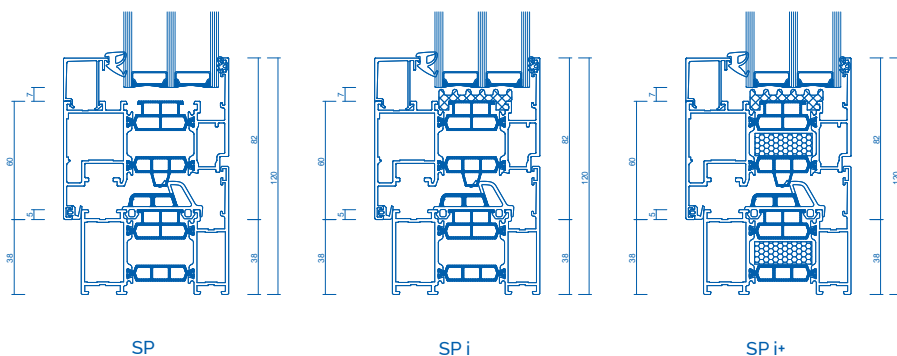

SUPERIAL 75 -

OPTIONS AND SUBSYSTEMS

Superial system and its thermal options (**SP** or **SP +**) and subsystems (**SP OUT**, **SP SU** or **SP 800**) allow a wide range of possibilities for external construction.

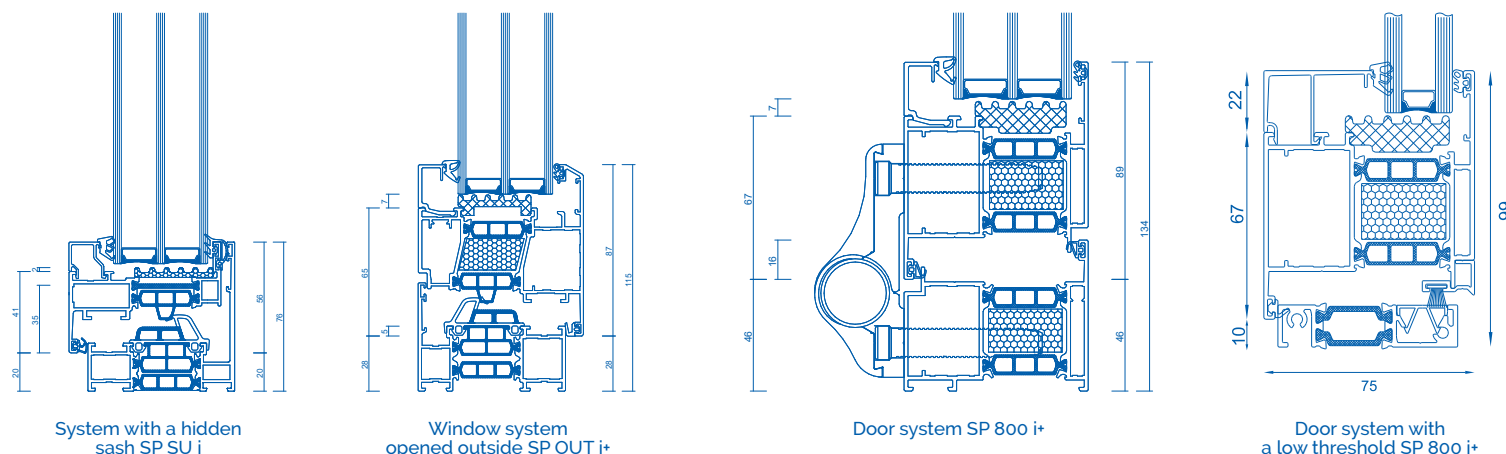

EXCELLENT THERMAL PERFORMANCE

A characteristic feature of the three-chamber Star 90 window and door system is increased by thermal insulation. Thanks to the use of innovative insulating components, thermal gasket under the glass, two types of central two-component gaskets and interlayer insulation element with a depth of 45 mm excellent thermal properties have been obtained - U_f ranging from 0.73 to 1.21 W/m²K. The system is built around a very wide 90 mm frame and 99 mm sash in the window system. As a standard, a three-glazed package with a thermal insulation coefficient $U_g = 0.5$ W/m²K is applied here. All this makes that the Star 90 system can be successfully used in low-energy houses.

STRENGTH AND DURABILITY

The new standard - a glass embedded deeper in the profil line - significantly improves the thermal and structural properties of the system.

COMPATIBLE WITH PANEL DOORS

The Star 90 system has special wings that make it possible to manufacture doors with **panels evened out in the frame** - on the outside or on both sides. This makes the door perfectly warm and looks very modern.

CROSS-SECTIONS THROUGH STAR 90

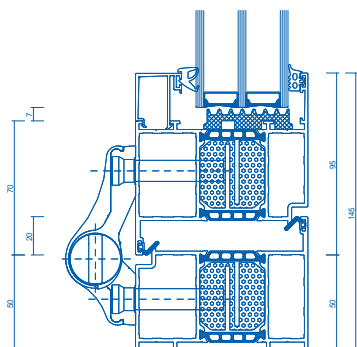

Cross-section through
STAR 90 door

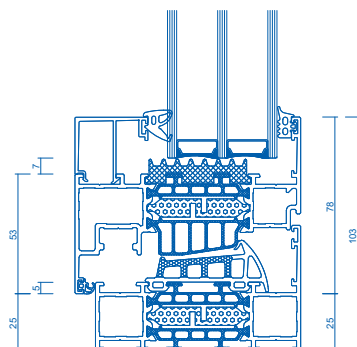

Cross-section through
STAR 90 window



PANEL DOORS
IN STAR 90 SYSTEM

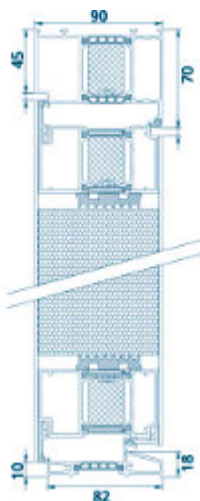

Cross-section through
frame and door leaf,
panel overlapped on both sides,
inward opening door,
PLUS version with insulation

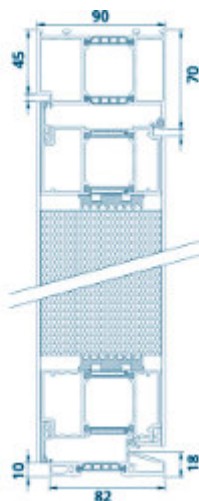

Cross-section through
frame and door leaf,
panel overlapped on both sides,
door opening inwards

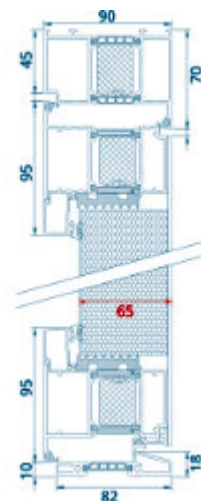

Cross- section through
frame and door leaf,
single- sided overlay panel,
inward opening door,
PLUS version with insulation

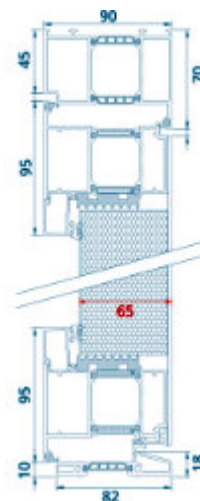

Cross- section through
the frame and door leaf,
one-sided overlapping panel,
door opening inward.

THERMAL PROPERTIES

Modern three-chamber system for windows and doors with the highest thermal insulation properties, meeting the requirements of European Directive 210/31/U, which is in force as of January 1, 2021. According to the new regulations, all newly constructed buildings should be characterized by the minimum energy demand necessary for their heating. Genesis 75 windows are characterized by a very low thermal insulation coefficient **U_f from 0.84 W/m²K**, which has been achieved through the use of 75 mm deep frame profiles and insulation materials which are new to the market. Application of an additional thermal gasket in addition to the standard central gasket allowed for obtaining very high tightness of the windows, while maintaining a modern design.

HIGH FUNCTIONALITY

Thanks to the variety of profiles offered within the system, it is possible to design all kinds of window, door and shop window structures, used both in public buildings, as well as in single- and multi-family housing.

AESTHETICS

The system is characterized by a combination of the highest ergonomics and modern aesthetics of profiles, so it allows designing window structures of individual character and innovative appearance.



CROSS-SECTIONS THROUGH GENESIS 75

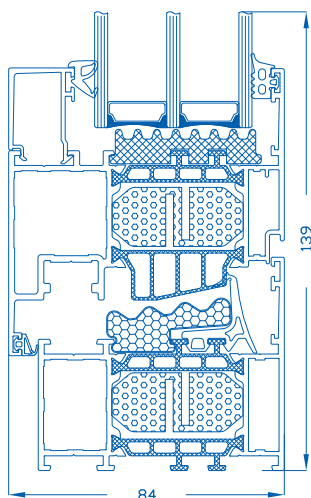

Cross-section through window
GN 013 + GN 022

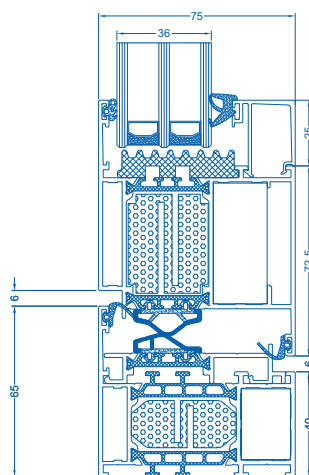

Cross-section through
frame and doors sash

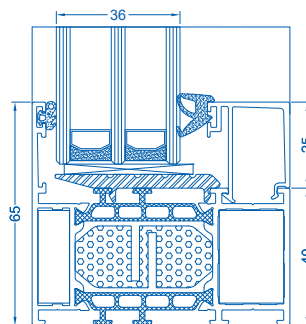

Cross-section through window
GN 75 (GN 011)

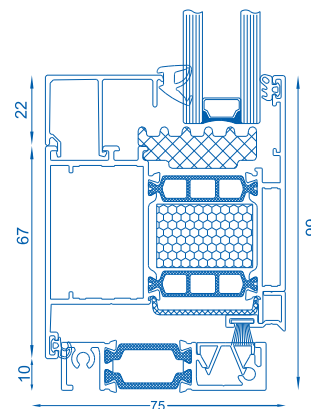

Cross-section through
panel door with a low threshold



TECHNICAL SPECIFICATIONS

SYSTEM	TYPE	THERMAL INSULATION U_f *	FRAME DEPTH	SASH DEPTH	GLAZING, FILLING DEPTH**
STAR 90	windows and displays	U_f form 0.73 W/m²K	90 mm	99 mm	fix 14-72 mm ru 23-81 mm
STAR 90	doors	U_f form 1.21 W/m²K	90 mm	90 mm	14-72 mm
STAR 90	panel doors	U_f form 0.73 W/m²K ***	90 mm	90 mm	evened out on one side 22-83 mm and on both sides 90 mm
GN 75	windows and displays	U_f form 0.84 W/m²K	75 mm	84 mm	fix 1-56 mm window 9-65 mm
SP	windows and displays	U_f form 1.41 W/m²K	75 mm	84 mm	14-61 mm
SP i+	windows and displays	U_f form 1.08 W/m²K	75 mm	84 mm	14-61 mm
SP 800	doors	U_f form 1.50 W/m²K	75 mm	75 mm	14-61 mm
SP 800 i+	doors	U_f form 1.10 W/m²K	75 mm	75 mm	14-61 mm
SP SU	hidden sash	U_f form 1.48 W/m²K	75 mm	78 mm	14-51 mm
SP SU i+	hidden sash	U_f form 1.12 W/m²K	75 mm	78 mm	14-51 mm
SP OUT	outwards opening	U_f form 1.65 W/m²K	75 mm	84 mm	max 61 mm
SP OUT i+	outwards opening	U_f form 1.41 W/m²K	75 mm	84 mm	max 61 mm
EF	window-door	U_f form 1.50 W/m²K	65-153 mm	74 mm	fix 4-51 mm window 13-59 mm
EF i	window-door	U_f form 1.44 W/m²K	65-153 mm	74 mm	fix 4-51 mm window 13-59 mm
EF i+	window-door	U_f form 1.27 W/m²K	65-153 mm	74 mm	fix 4-51 mm window 13-59 mm
EF OC	hidden sash	U_f form 1.66 W/m²K	65-177 mm	68 mm	fix 21-26 mm window 21-26 mm
IP	windows and displays	U_f form 1.57 W/m²K	65 mm	74 mm	4-51 mm
IP i+	windows and displays	U_f form 1.28 W/m²K	65 mm	74 mm	4-51 mm
IP 800	doors	U_f form 1.60 W/m²K	65 mm	65 mm	14-50 mm
IP 800 i+	doors	U_f form 1.40 W/m²K	65 mm	65 mm	14-50 mm
IP SU	hidden sash	U_f form 1.63 W/m²K	65 mm	68 mm	fix 4-51 mm window 14-41 mm
IP SU i+	hidden sash	U_f form 1.27 W/m²K	65 mm	68 mm	fix 4-51 mm window 14-41 mm
IP OUT	outwards opening	U_f form 1.85 W/m²K	65 mm	74 mm	max 51 mm
IP OUT i+	outwards opening	U_f form 1.68 W/m²K	65 mm	74 mm	max 51 mm
EL	windows and displays	-	51 mm	60 mm	to 37 mm
EL	doors	-	51 mm	51 mm	to 34 mm
EL	panel doors	-	51 mm	51 mm	51 mm

SAMPLE COLOUR PALETTE

Aliplast windows and doors are available in all RAL colours. In addition, they can be made in the Aliplast Wood Colour Effect palette, which perfectly reflects the beauty of wood-like colours or in the palette of Tiger and IGP structural coatings with a characteristic texture, with a choice of gloss, the so-called pearl or without. Also an interesting solution is an option of creating a two-colour structure of inner and outer profiles with a different colour each.

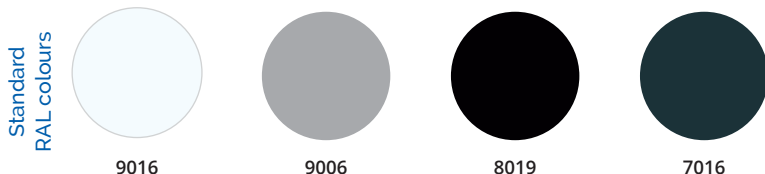

*Thermal insulation depends on the thickness of filling and the assembly of the profile | **For panel doors
***For doors with dimensions of 1200 x 2100 mm